

LDG PROPERTIES, L.L.C. PRELIMINARY PLAT BOUNDARY

WILES BROS., INC.

WILES BROS., INC.

WILES INVESTMENT CO., LTD.

WILES INVESTMENT CO., LTD.

WILES BROS., INC.

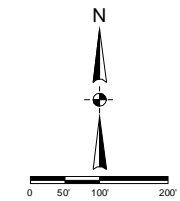

LEGEND

- PROPERTY BOUNDARY
- PROPERTY LINE
- EASEMENT
- RIGHT-OF-WAY
- CENTERLINE
- PAVEMENT
- BUILDING SETBACK
- SS SANITARY SEWER
- W WATER MAIN

NOTES:

1. WATER MAINS SHALL BE 10" MINIMUM DIAMETER UNLESS OTHERWISE NOTED. ACTUAL SIZING SHALL BE DETERMINED AT THE TIME OF FINAL DESIGN.
2. ALL POWER SHALL BE INSTALLED BY N.P.D.D.
3. ALL SANITARY SHALL BE 8" UNLESS OTHERWISE NOTED.

A 30' WIDE SANITARY SEWER EASEMENT SHALL BE GRANTED OVER THE SANITARY SEWER LINE FROM THE EAST PROPERTY LINE OF WILES CROSSING TO THE NORTH RIGHT OF WAY LINE OF WILES ROAD, IF STREET RIGHT OF WAY HAS NOT BEEN DEDICATED PRIOR TO OR AT THE TIME OF CONSTRUCTION OF THE SEWER MAIN.

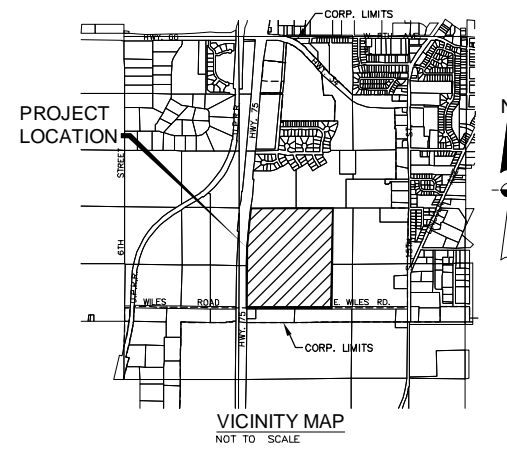

NO.	DATE	DESCRIPTION
1	8-22-07	REVISED PRELIMINARY PLAT PER PLANNING COMMISSION

THIS PROJECT HAS BEEN REVIEWED AND APPROVED FOR CONSTRUCTION BY THE PLANNING COMMISSION OF THE CITY OF PLATTSMOUTH, NEBRASKA.

WILES CROSSING
PLATTSMOUTH, NEBRASKA

UTILITY PLAN

PROJECT NO.:	016001-06
DATE:	AUGUST, 2007
DESIGNED:	AWY
DRAWN:	CAB
CHECKED:	RLD
SHEET NO.:	3 OF 6

ENGINEERING, INC.
1000 N. HARRIS STREET, SUITE 201
PLATTSMOUTH, NEBRASKA 68403
402.886.4338 (P) 402.886.4338 (FAX)

Small vertical text at the bottom left corner, likely containing project details or contact information.